

ZIPPITY

Easy Does It!

ZIPPITY POOLSIDE ORGANIZER (36" W X 64" L X 38" H)

ASSEMBLY INSTRUCTIONS ZP19061

60 MIN

Approximate assembly time for entire product

Want to see a video on how to
assemble this product?
Scan the QR code

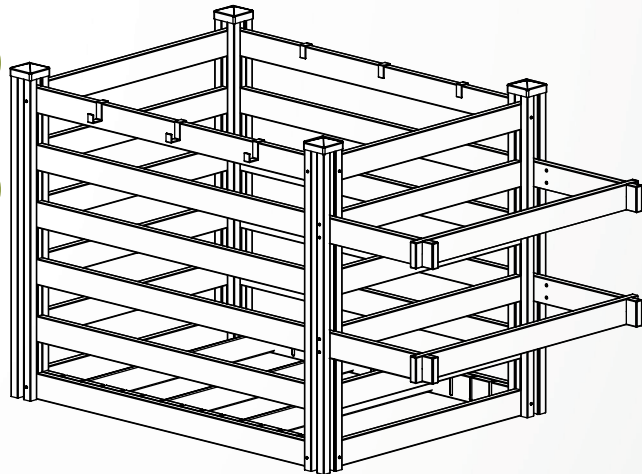

GENERAL INFORMATION



IMPORTANT

- + Check the inside of the larger pieces in your box for other materials packed inside.
- + When assembling components, place on a non-abrasive surface (i.e. shipping box) to avoid scratching.
- + We recommend an area approximately 5'x 8' for unobstructed assembling.
- + You should not need to use excessive force when assembling components.

MISSING OR DAMAGED PARTS?

VISIT OUR WEBSITE FIRST, SO WE CAN HELP YOU RIGHT AWAY!

Although great care has been taken to ensure proper packaging and handling of this product, occasionally problems occur. If you discover any missing, damaged, or defective parts, please visit our website to order replacement parts. If you experience any further trouble with your product, please contact our customer service department.

 parts.nychbrands.com

 support@zippity-outdoor.com

 **704-892-5222 / 877-234-6196**

Customer service agents are available to take calls weekdays from 9am-5pm EST. If you call outside of business hours, please leave a voicemail.

To help you quickly and accurately, please have reference item number **ZP19061** and the specific part name which can be found on page 4. It is helpful if you can provide the batch lot which is a stamped number on the inside of the box.

NEED ASSEMBLY HELP?

If you are having problems with the assembly or installation of this product, we are happy to assist you with the process, **so please give us a call at 704-892-5222 / 877-234-6196.**

NEED TO RETURN?

If for some reason you need to return this product, please allow us to help resolve your issues first. If you still decide to return the product, **you will need to initiate the return from the company you originally purchased from.**

Detailed Product Dimensions & Specifications

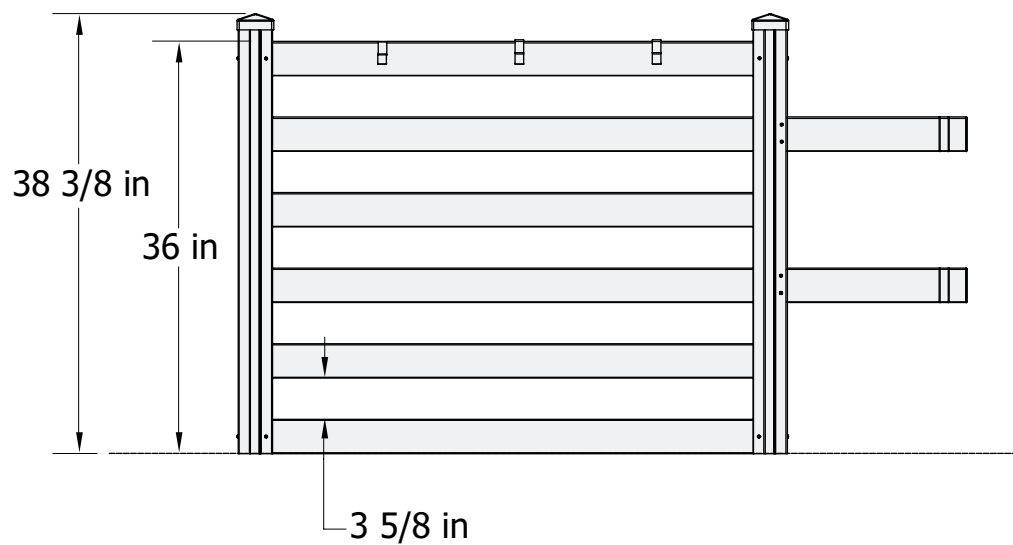
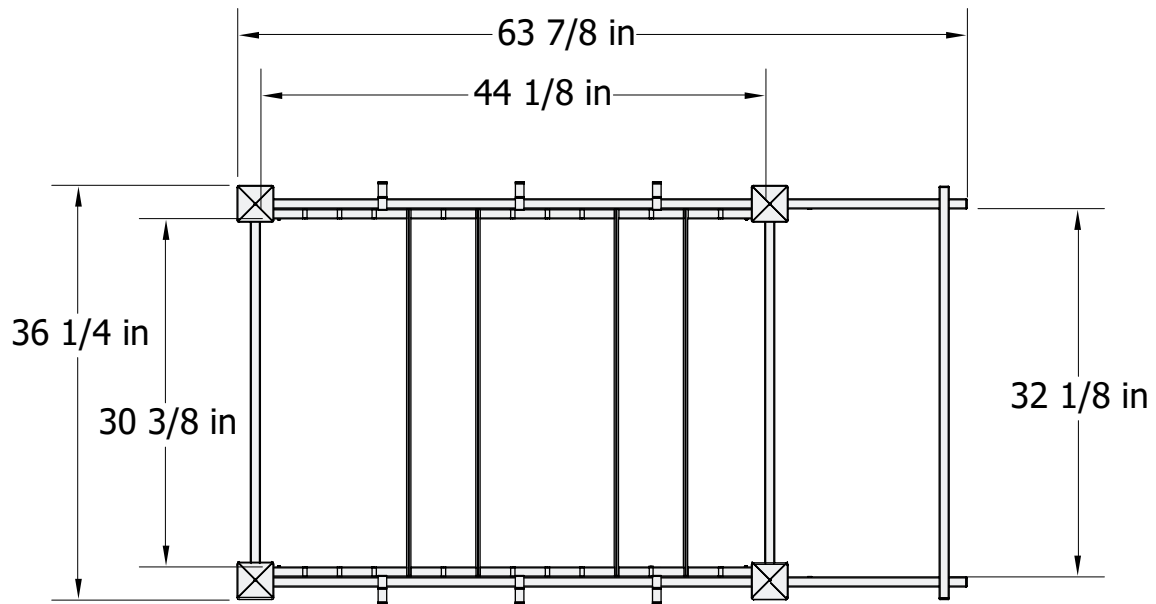

STEP 1: LAY OUT MATERIALS

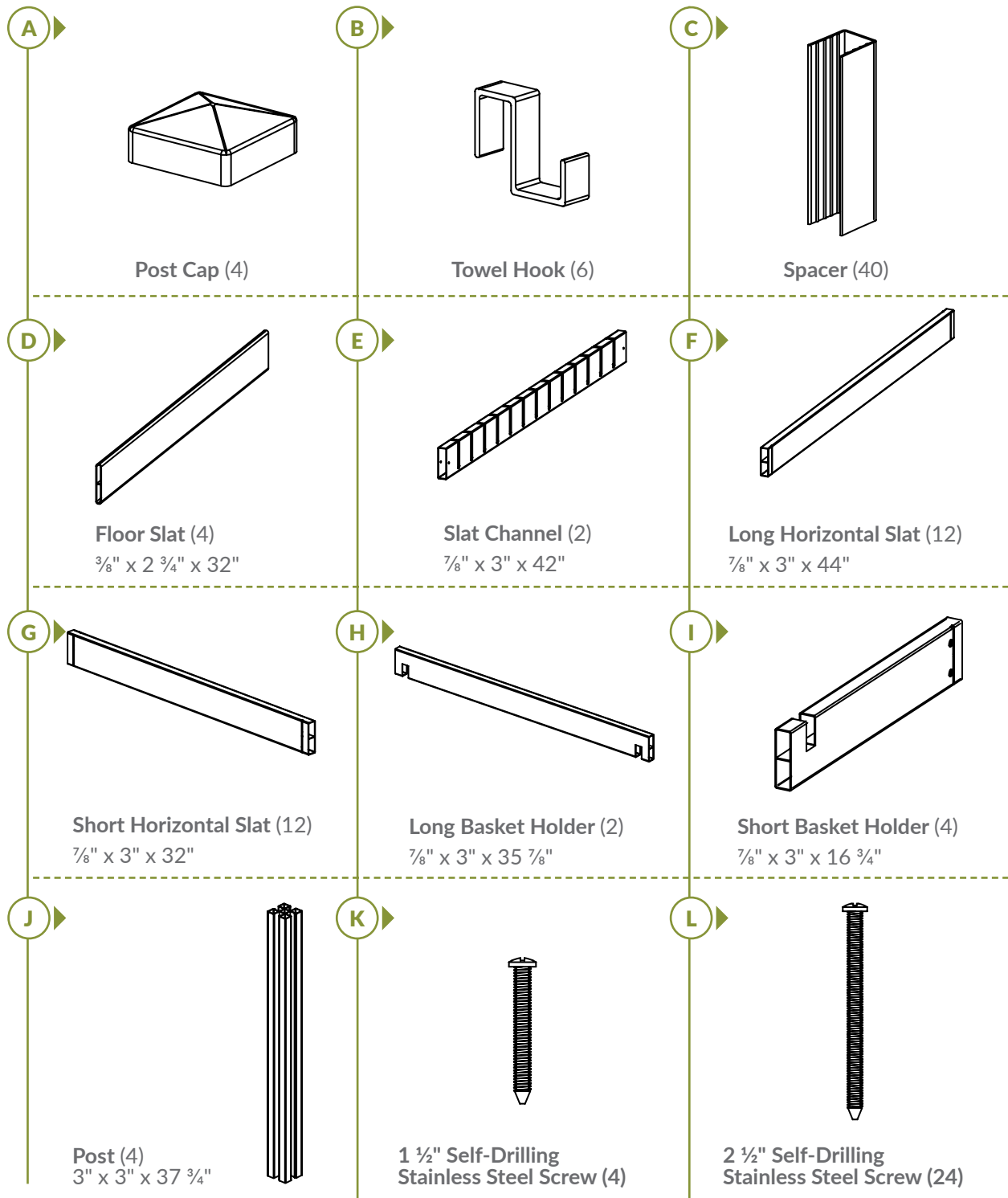

STEP 2: ASSEMBLE FIRST SLATS

STEP 2.1 ▶

Lay out the Posts (**J**) with the tabs oriented as shown below.

NOTE: Orientation of tabs in this step is critical to future install.

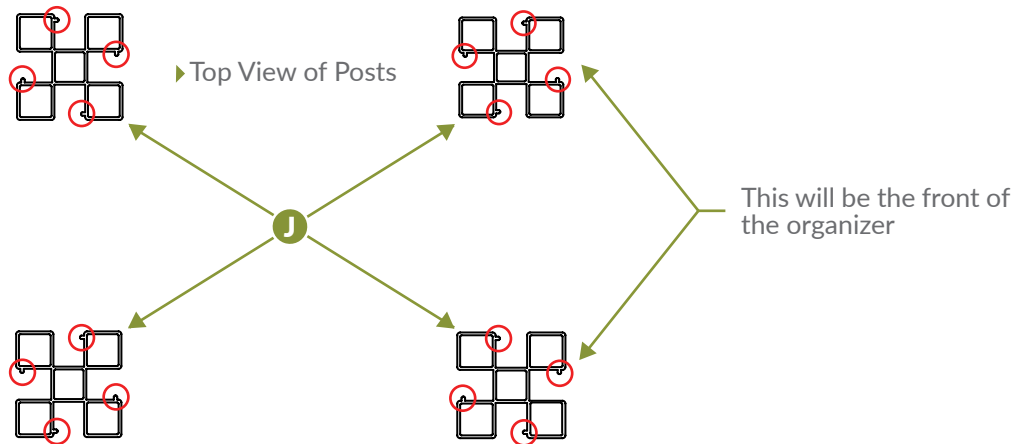

STEP 2.2 ▶

1. Take (2) Long Horizontal Slats (**F**) and insert them into the channels of the posts ensuring the tabs line up with the grooves in the slats.
2. Drive (4) total 2½" Self-Drilling Stainless Steel Screws (**L**) into the post channels as shown to secure the long horizontal slats.

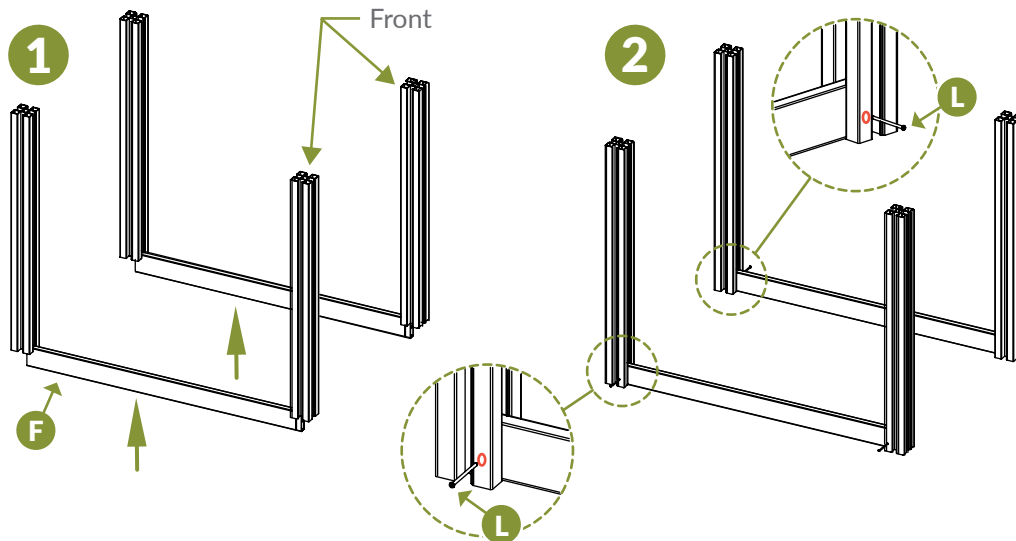

STEP 2.3 ▶

1. Take (2) Short Horizontal Slats (**G**) and insert them into the channels of the posts ensuring the tabs line up with the grooves in the slats.
2. Drive (4) total 2 ½" self-drilling stainless steel screws into the posts as shown to secure the short horizontal slats.

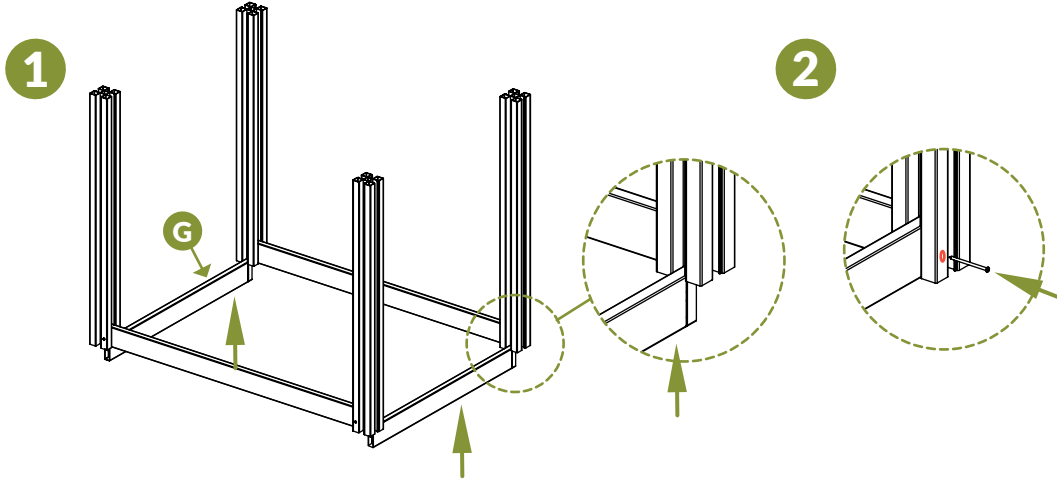
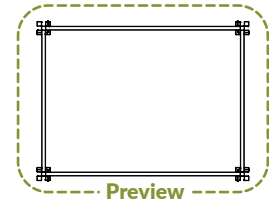
**STEP 3: INSTALL FLOOR SLATS****STEP 3.1** ▶

1. Take (1) Slat Channel (**E**) and place it between the two posts against the long horizontal slat.
2. Drive (2) 1 ½" Self-Drilling Stainless Steel Screws (**K**) into the pre-drilled holes in the slat channel.
3. Repeat with the second slat channel on the opposite side.

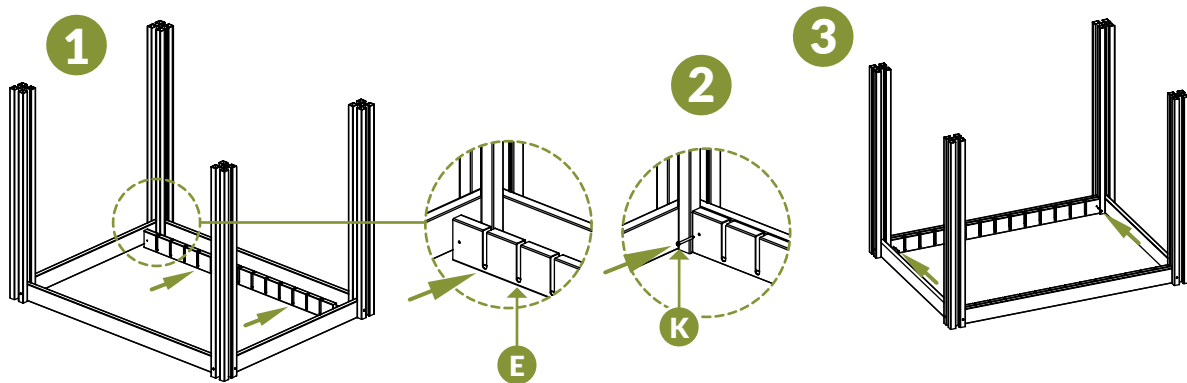
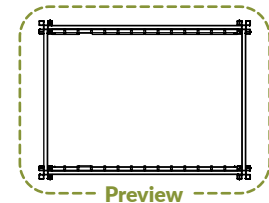

STEP 3.2 ▶

Insert the (4) Floor Slats **(D)** into the notches in the slat channels.

NOTE: These slats can be arranged differently depending on the application to assist with organization.

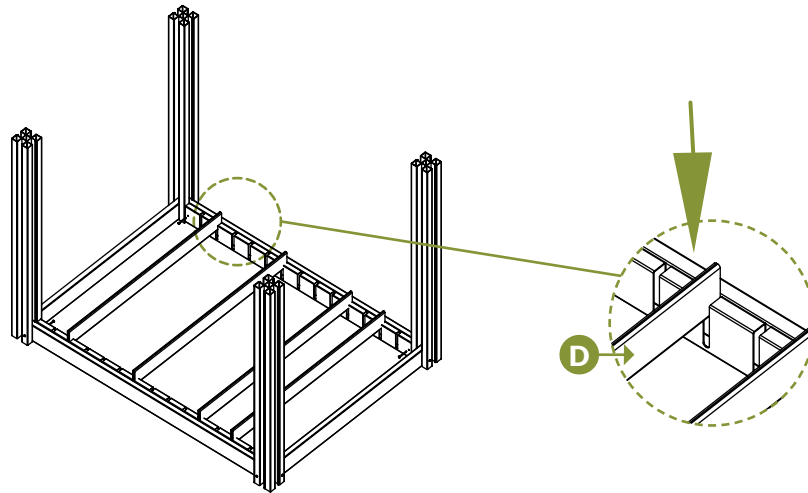
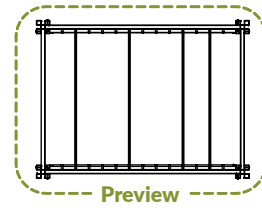
**STEP 4: ASSEMBLE ADDITIONAL SLATS****STEP 4.1** ▶

Slide (8) Spacers **(C)** into the grooves of the posts directly on top of the horizontal slats as shown below.

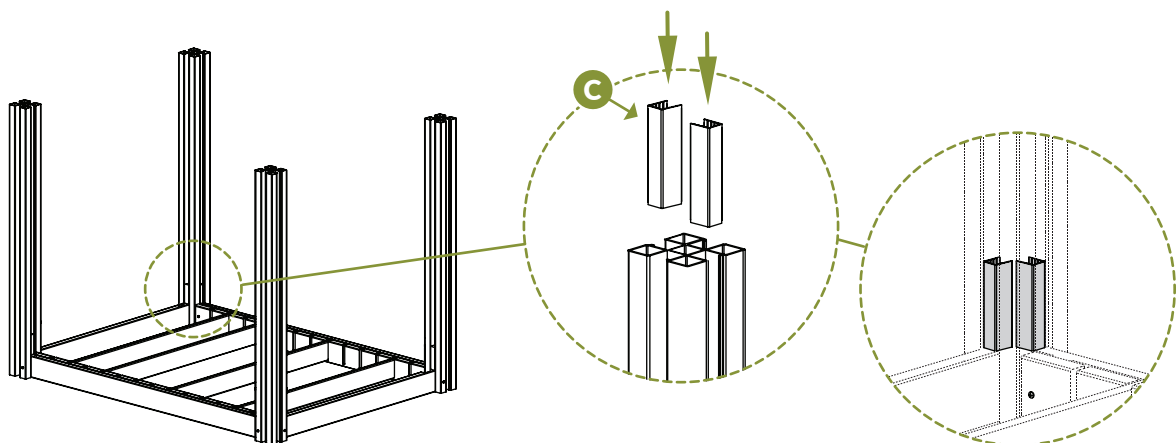
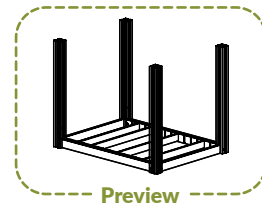

STEP 4.2 ▶

1. Slide (2) long horizontal slats and (2) short horizontal slats down the post channels, as shown, ensuring the post tabs align with the notches in the horizontal slats.
2. Add the remaining spacers and the horizontal rails into the post channels.
3. Drive (8) total 2 ½" self-drilling stainless steel screws into the posts as shown below to secure the top horizontal slats.

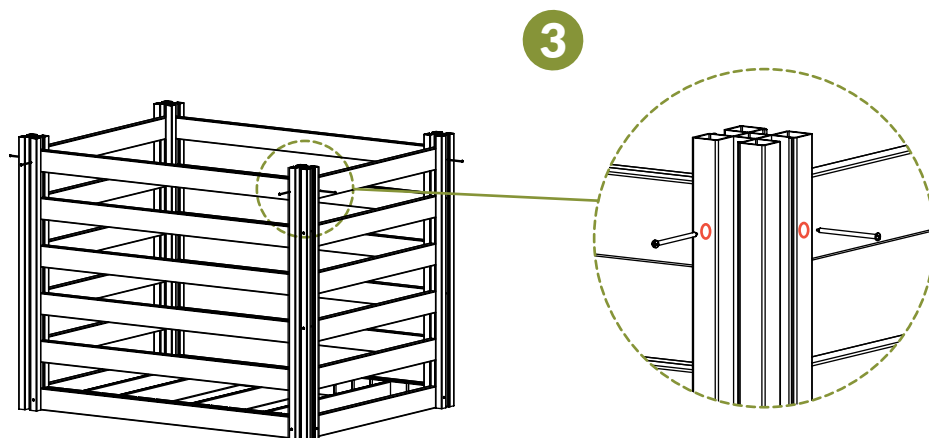
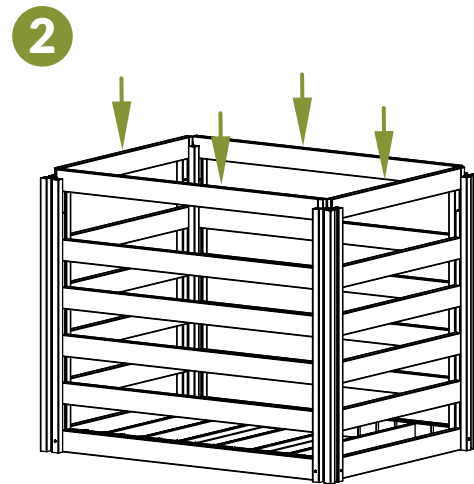
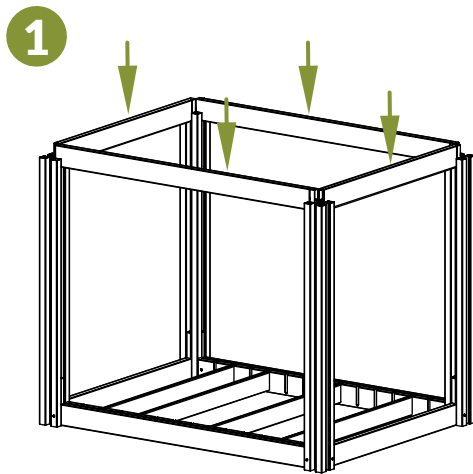
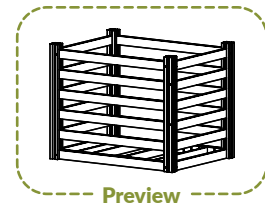

STEP 5: INSTALL BASKET HOLDERS

STEP 5.1 ▶

1. Slide (2) Short Basket Holders (I) down the post channels on the front of the organizer.
2. Drive (4) 2 ½" self-drilling stainless steel screws into the post to secure the short basket holder parts.
3. Repeat for the other two short basket holders.

NOTE: Basket holders are designed to hold "Sterilite 16268006 Large Ultra Basket"

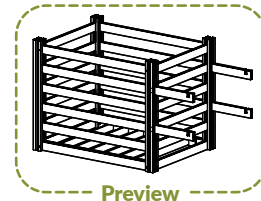

1

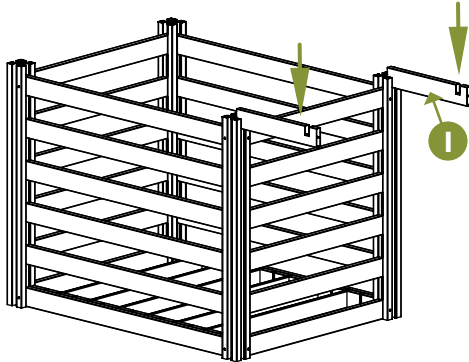

2

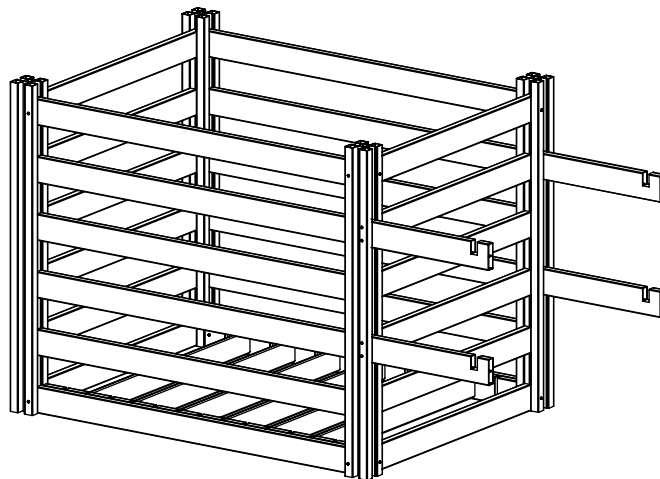
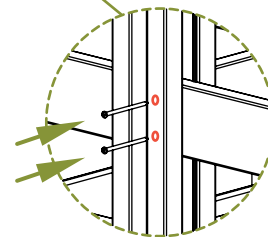
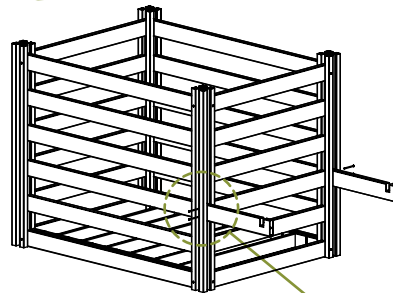

STEP 5.2 ▶

Insert (2) Long Basket Holders (**H**) over the notches in the short basket holders.

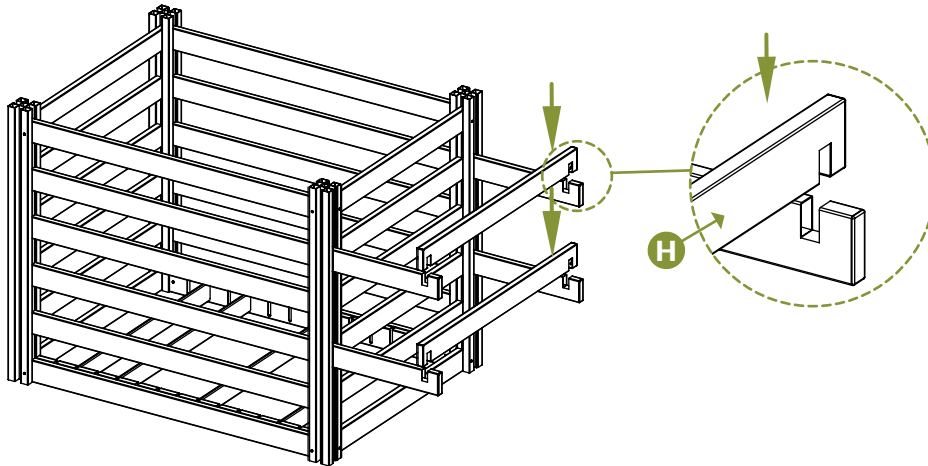
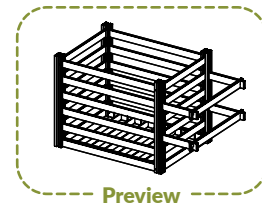
**STEP 6: ADD CAPS AND HOOKS****STEP 6.1** ▶

1. Insert (6) Towel Hooks (**B**) over the horizontal slats at the desired location.
2. Place (4) Post Caps (**A**) over the tops of the posts to complete the assembly.

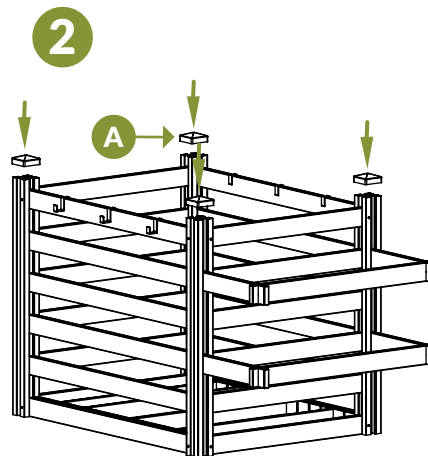
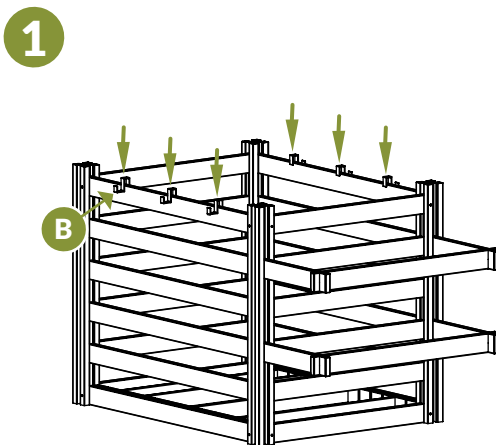
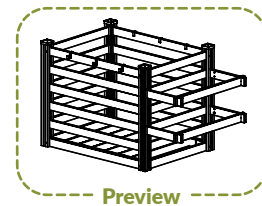



ZIPPITY

Easy Does It!



6935 Reames Rd. Ste. K.
Charlotte, NC 28216



support@zippity-outdoor.com

704-892-5222
877-234-6196



WWW.ZIPPITY-OUTDOOR.COM